

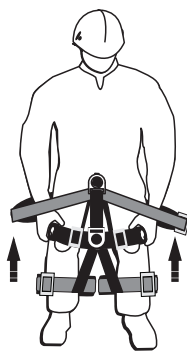

## 6 INSTRUCTIONS OF USE

### 1° STEP



To wear it is necessary to first check if the breastplate is up; Wrap your legs inside harness waist and put your legs inside harness leggings; Place the harness at the waistline in the correct position.

### 2° STEP

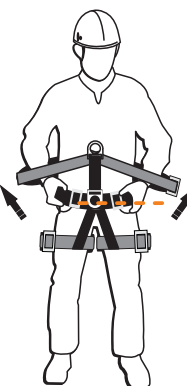

Fit the straps at the waistline through the buckles, snugly but comfortably.

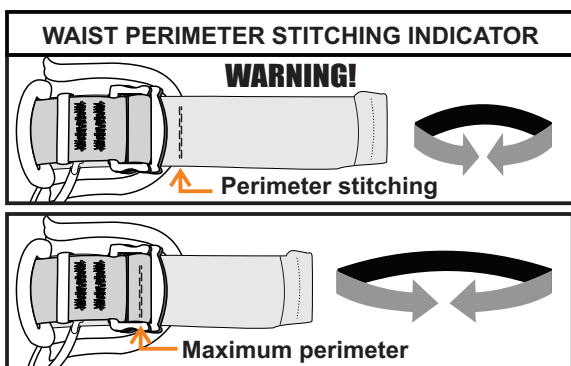
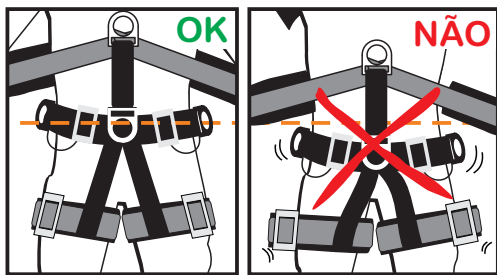

### 3° STEP

Dress the upper/pectoral part by positioning the belt correctly over the V-shaped shoulders.

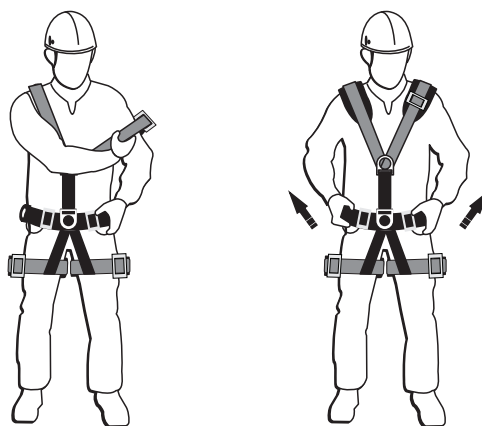

### 4° STEP

Also adjust the leggings buckles. Make sure the buckles are facing outward, closed, and the padded circumference is well-positioned.

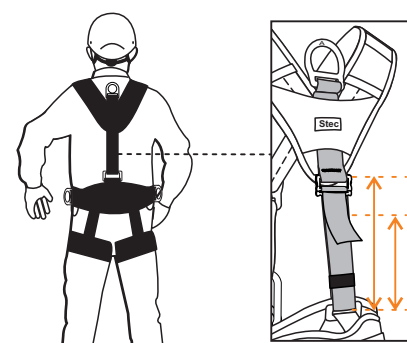
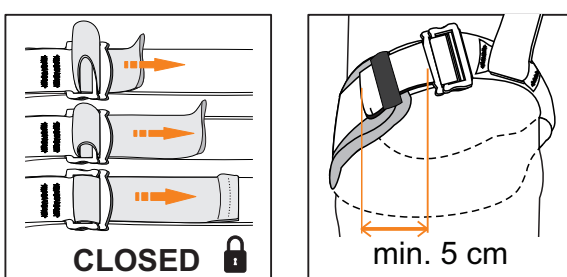

Back Adjustment.

### 5° STEP

Adjust the buckle in the back to its size. Before use, verify that the harness fits properly and provides comfort and safety.

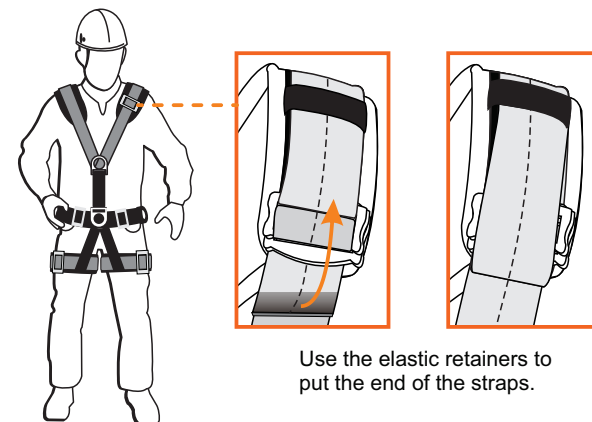

Use the elastic retainers to put the end of the straps.

## 7 ATTACHMENT POINTS

STERNAL "D"-RING ATTACHMENT POINT: FALL ARREST SYSTEM ATTACHMENT

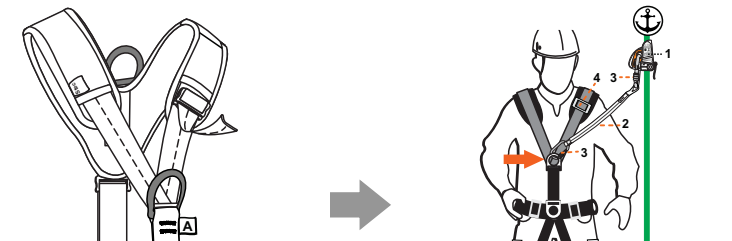

DORSAL "D"-RING ATTACHMENT POINT: FALL ARREST SYSTEM ATTACHMENT

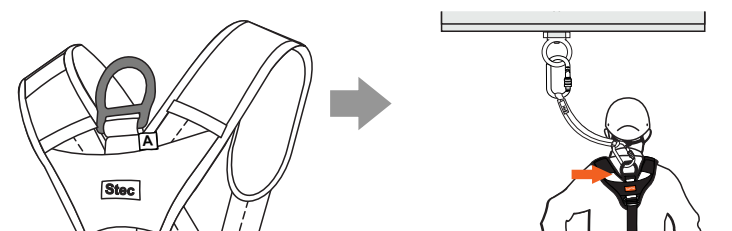

## 8 WORK POSITIONING

LATERAL "D"-RING ATTACHMENT POINTS: ATTACHMENT FOR A POSITIONING LANYARD FOR USE IN DOUBLE MODE

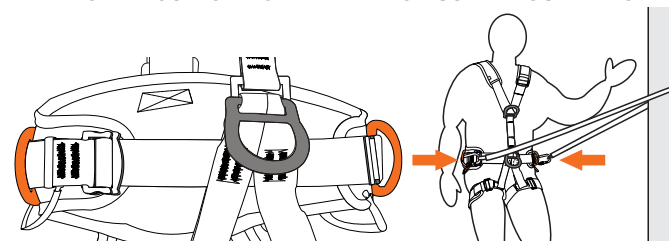

VENTRAL "D"-RING ATTACHMENT POINT: ATTACHMENT FOR A DESCENDER OR A POSITIONING LANYARD FOR USE IN SINGLE MODE

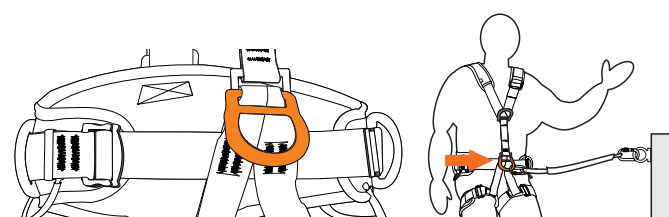

### WARNING!

Rescues should be planned and generally designed to limit the exposure of rescue team members. On-Rope Rescue should only be undertaken if the casualty is in urgent need of medical attention that requires evacuation. Additional training and competence is required for all persons performing rescues.



## 9 HOW TO USE

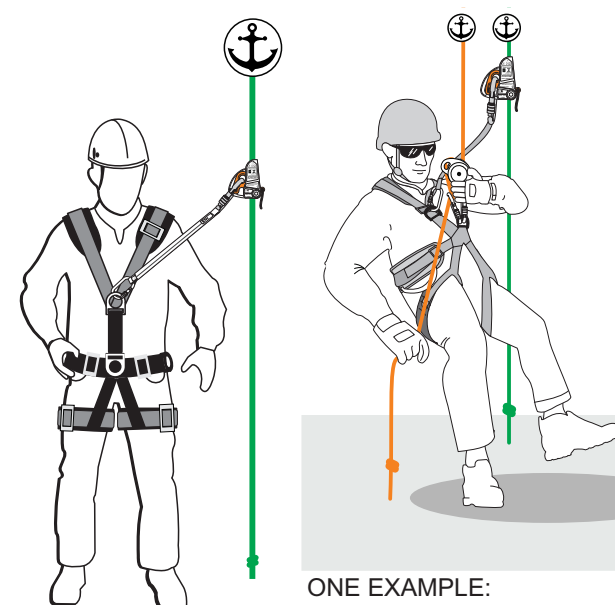

### Operational check:

While wearing the harness, the user should hang in suspension with his equipment to verify that the harness is adequate for intense use. Make all the necessary adjustments before start work.

## 10 CLEARANCE DISTANCE

Free Zone of Fall is the distance found by multiplying the maximum length of the extender (L1) x 2, and add the height of the operator (H) plus 1 meter. Example: L1 = 0,7 m (EX03 Extender + 2 COB connectors) H = 1,7 m (operator height).  
 $ZLQ = 2L + H + 1.20m$

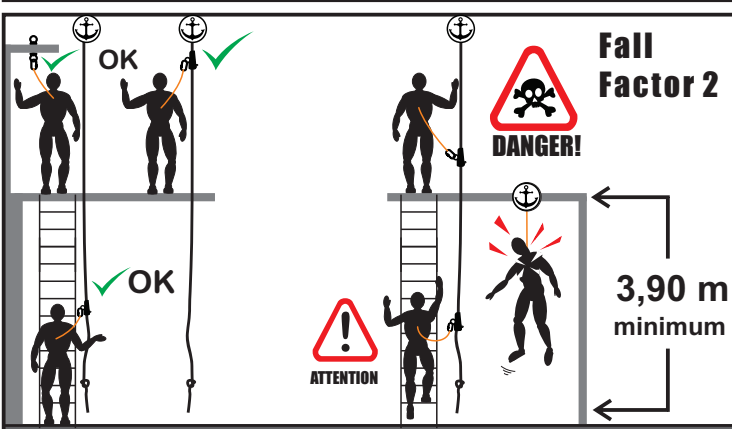
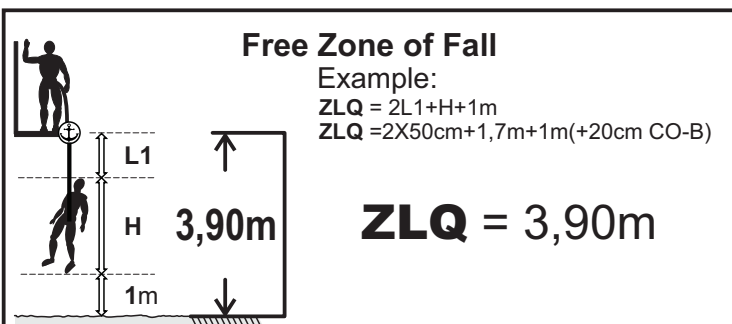

NOTE: This example of ZLQ only covers the use for CF = 2 (Fall Factor 2). When used with other equipment the ZLQ may increase or decrease. Check the workplace.

## 11

## GENERAL INFORMATION

Read and understand this manual prior to use and save for future reference. Only the techniques presented in this manual are authorized. Some examples of miss-use are included, these have a stripe or pictogram of a skull and should be avoided, these are some examples of miss-use, it is impossible to foresee all ways equipment can be miss-used and users should never use equipment in ways that are not 100% verified prior to being used to provide personal safety, in case of doubt contact S.Tec. When any doubt exists regarding its efficiency equipment must not be used.

**Sea Water:** it is essential that this product is cleaned as soon as practicable after each exposure to sea water or saline environment.

**Chemical reagent:** avoid contact with any substance or material that may causes corrosion or other damage to the any material or working action of the device. If contact occurs consult expert advice as to damage and decontamination requirements. Inspect prior to any re-use.

**Disinfection:** following any contamination the source of the contamination should be determined and advice obtained as to suitable disinfecting procedure. After disinfection the device should be re-cleaned. Sterilization may be required.

**Cleaning:** If soiled rinse in clean warm water of domestic supply quality (maximum temperature 40°C) with mild detergent at appropriate dilution (pH range 5.5 - 8.5). Dry naturally away from direct heat sources. To remove grease use a detergent that has properties that do not affect the textile or metal components.

**Lifespan:** it is very difficult to define the safe lifespan due to

varying use and storage conditions and may be as little as one use, or even earlier if damaged (e.g. in transit or storage) prior to first use. For the product to remain in service it must pass a visual and tactile examination. Maximum lifespan: 5 years from 1st use or 10 years without use.

**Warranty:** The Rope Access Complet full body harness has a 1 year warranty against manufacturing defects, proof of purchase required. The warranty does not cover use wear, miss-use, abuse, neglect or any alterations, maintenance or repairs performed outside the factory.

**Obsolescence:** this product may become obsolete before the end of its lifespan. Reasons for this may include changes in applicable standards, regulations, legislation, development of new techniques, incompatibility with other equipment etc.

Declaration of Conformity: Can be accessed on [www.safetecbr.com.br](http://www.safetecbr.com.br)

**Do not store wet.**